

# COBRA CLASS

7

## TABLE OF CONTENTS

## PAGE

|  |    |
|--|----|
| INSTRUCTIONS                               | 2  |
| SPECIFICATIONS                             | 2  |
| MACHINE INSTALLATION                       | 2  |
| MOTOR INSTALLATION                         | 3  |
| FOOT PEDAL AND COUPLING LEVER INSTALLATION | 3  |
| PRESSER FOOT PEDAL INSTALLATION            | 4  |
| BOBBIN WINDER INSTALLATION                 | 4  |
| THREAD STAND INSTALLATION                  | 5  |
| PREPARATION BEFORE USE                     | 5  |
| LUBRICATION                                | 5  |
| COMMISSIONING                              | 6  |
| SET THE NEEDLE                             | 6  |
| REMOVE THE BOBBIN                          | 7  |
| THREAD THE NEEDLE                          | 8  |
| ADJUST STITCH LENGTH                       | 8  |
| ADJUST PRESSER FOOT LIFT                   | 9  |
| ADJUST NEEDLE THREAD                       | 9  |
| ADJUST PRESSURE OF PRESSER FOOT            | 10 |
| PARTS LIST & ILLUSTRATIONS                 | 11 |



## 1. INSTRUCTIONS

GA733 is a top and bottom feed extra heavy duty sewing machine which has a special designed high rigidity machine frame. It's very easy for sewing large products on the big working space. GA733 have super force and sewing capacity from large inertia pulley. Alternating presser feet and feed dog feeding mechanism make good stitching performance and material feed. It's a well-suited machine of sewing extra heavy duty material and multilayer material. GA733 also have good performance on sewing of slipped and sticky material. Cam type take-up and half rotary extra large shuttle hook are installed to form the seam. The large hook can increase volume of winding, improve work efficiency. GA733 is a ideal machine for sewing auto products (air-bag, seat cushions, life belt, etc.), handbags, baseball gloves, harness, tents, polishing wheel, parachute bag, suitcase, golf bag, sail and bookbinding.

## 2. SPECIFICATIONS

|                   |         |                             |
|-------------------|---------|-----------------------------|
| Model             |         | GA733                       |
| Max. sewing speed |         | 700s.p.m                    |
| Stitch length     |         | 10-15mm                     |
| Presser foot lift | By hand | 29mm                        |
|                   | By knee | 32mm                        |
| Needle size       |         | SM×1000 27#                 |
| Thread            |         | 0#-00#                      |
| Shuttle hook      |         | KSP7-31                     |
| Lubrication       |         | Manual                      |
| Motor             |         | 550W Clutch motor 1400r.p.m |

## 3. MACHINE INSTALLATION

### 3.1 Place

The GA733 heavy duty sewing machine should be mounted in a stabilization base. Place shockproof rubber washer between machine stand and ground will reduce the shock of machine and operating noise.

### 3.2 Bed bracket and oil pan installation

Mounting the bed bracket under sewing table and then fix the oil pan on the bracket by screw.

### 3.3 Machine installation

Place the machine on the bed bracket by four supporting foot and adjust the machine into steady position.

#### 4. MOTOR INSTALLATION

Mounting the motor by three motor mounting screw. Adjust the position of motor(C) and make the balance wheel(Machine pulley) belt guidance and motor pulley belt guidance are collinear. Observe the Fig. 1.

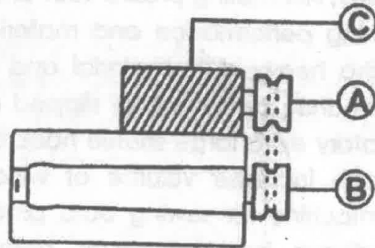

Fig.1

#### 5. FOOT PEDAL AND COUPLING LEVER INSTALLATION

- 5.1 Foot pedal(A) should be mounted as 20°-30° angle between ground.
- 5.2 Adjust the coupling lever(E) and make collinear of machine pull rod(B) and coupling lever(C).
- 5.3 The machine rotation direction should be anticlockwise look from machine pulley(G) side. The motor(D) should be running in same direction.
- 5.4 Regulate timing belt tension by changing height of motor. Pressing the lateral of timing belt, if the timing belt can be extrude 10-12mm and reinstate after release, the timing belt will in a suitable tension.
- 5.5 The mounted position of foot pedal can be adjusted according to work habit of operator. Observe the Fig.2.

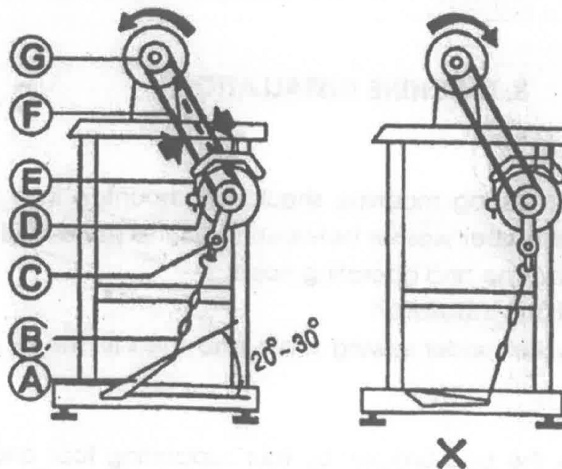

Fig.2

## 6. PRESSER FOOT PEDAL INSTALLATION

Link the presser foot left chain(A) and presser foot left rod(C) by hook(A).  
Mounted presser foot pedal(D) on machine stand crosspiece. Adjust board(E)  
position and fixed all bolt and nut.  
Observe the Fig.3.

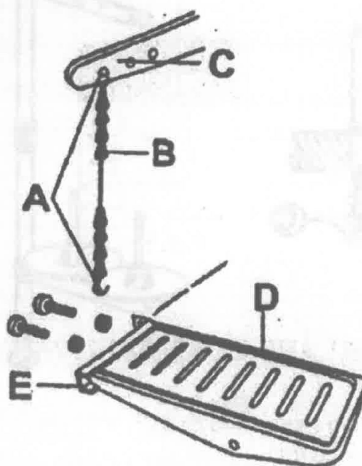

Fig.3

## 7. BOBBIN WINDER INSTALLATION

The bobbin winder is mounted on the table top as shown in Fig.4 with its pulley in front of the driving belt so that the pulley will separate from the belt after bobbin has been wound with sufficient thread.

Screw(B) adjust the central position of bobbin winder.

Screw(C) adjust the bobbin winder.

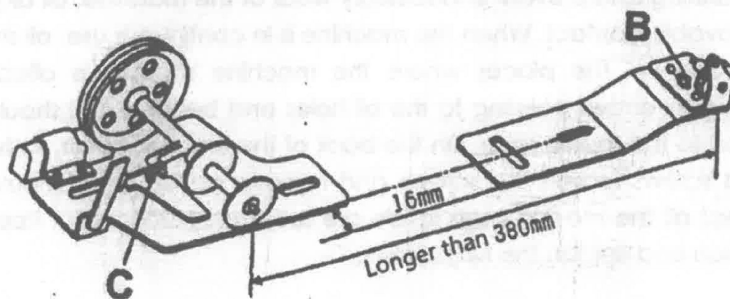

Fig.4

## 8. THREAD STAND INSTALLATION

The thread stand should be mounted in top right corner of table top, fixed by nut(C).

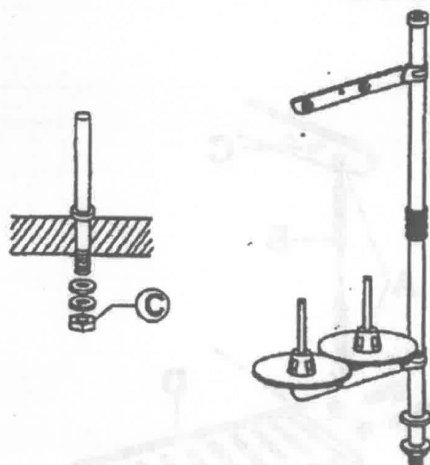

Fig.5

## 9. PREPARATION BEFORE USE

9.1 Before packing, we put anti rust grease in the component of machine. Please wipe off the grease in the surface and clean the machine.

9.2 Check

Please check the machine carefully and turn rotatable parts.

## 10. LUBRICATION

To insure easy running and prevent unnecessary wear of the machine, oil all parts which are in movable contact. When the machine is in continuous use, oil should be applied frequently. The places where the machine should be oiled are indicated in Fig.6 by arrows pointing to the oil holes and bearings. Oil should be regularly applied to the shuttle race. On the back of the arm is a cover, fastened by two knurled screws loosen the screws and remove cover. Care should be taken to see that all the moving parts inside are sufficiently lubricated. Replace cover into position and tighten the two screws.

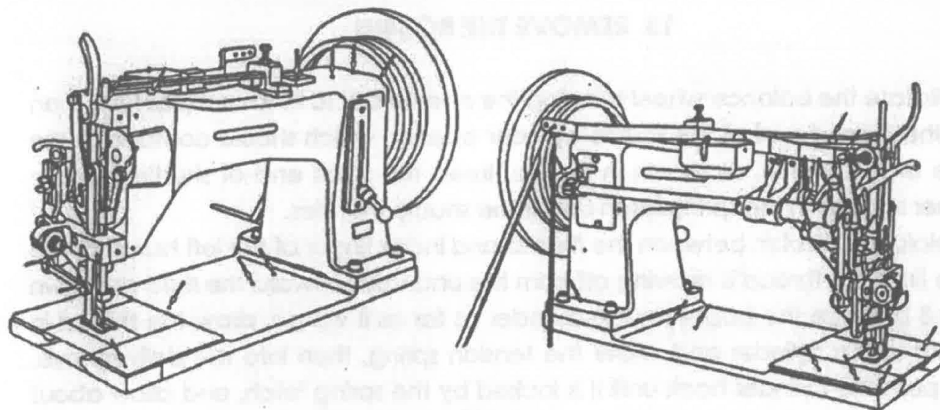

Fig.6

## 11. COMMISSIONING

The new machine should be commissioning operation in low speed. Lift the presser foot and control the operation speed in 300-400 stitch per minute for half hour.

## 12. SET THE NEEDLE

Rotate the balance wheel until the needle bar has reached its highest position. Loosen the thumb nut in the needle clamp and place the needle up into the clamp as far as it will go. The long groove of the needle must be facing left and the eye in line with the arm of the machine. Then tighten the set screw. Observe the Fig.7.

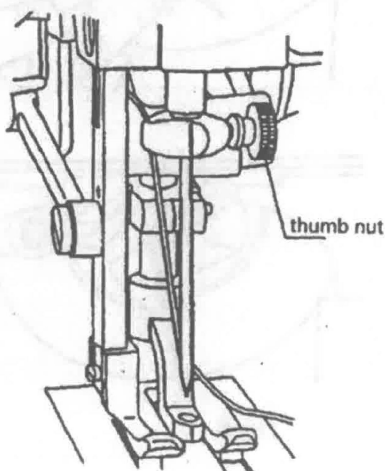

Fig.7

### 13. REMOVE THE BOBBIN

13.1 Rotate the balance wheel bringing the needle bar to its lowest position. Then with the curved part of the shuttle cylinder opener, which should conform to the curve of the shuttle, as shown in Fig.8 a, insert the small end of shuttle cylinder opener into slot in the spring latch under the shuttle cylinder.

13.2 Hold the bobbin between the thumb and index finger of the left hand, at the same time the thread is drawing off from the underside toward the right as shown in Fig.8 b. Place the bobbin in the cylinder as far as it will go, draw the thread in the slot in the cylinder and under the tension spring, then into the delivery eye, then push the cylinder back until it is locked by the spring latch, and allow about 3 inches of thread to hang free from the shuttle so that it can be drawn up through the throat plate.

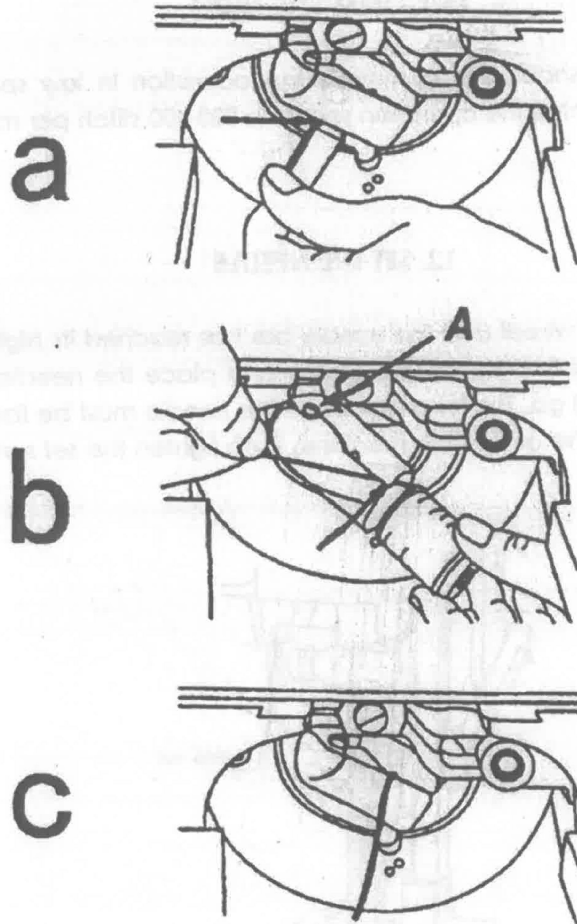

Fig.8

#### 14. THREAD THE NEEDLE

Observe the Fig.9.

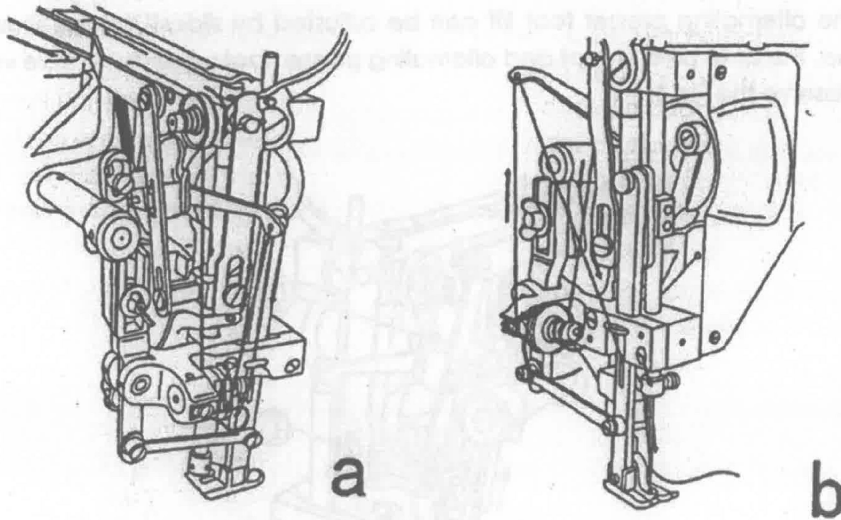

Fig.9

#### 15. ADJUST STITCH LENGTH

The length of stitch is regulated by loosening the serrated nut(A) on the reverse lever, Fig.10.

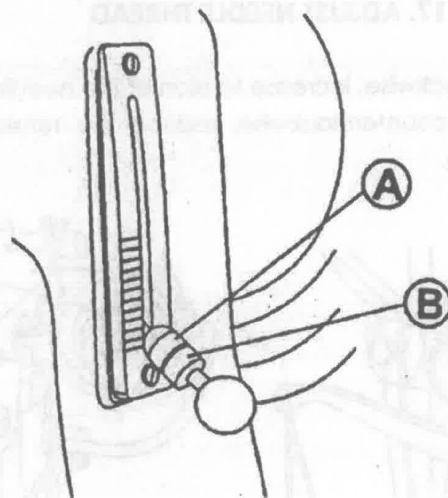

Fig.10



## 16. ADJUST PRESSER FOOT LIFT

16.1 The presser foot lift can be adjusted by Screw(C). If the screw(C) goes up, the lift of presser foot and alternating presser foot will reduce, vice versa.

16.2 The alternating presser foot lift can be adjusted by slides(D). If the slides(D) goes up, the lift of presser foot and alternating presser foot will reduce, vice versa.

16.3 Observe the Fig.11.

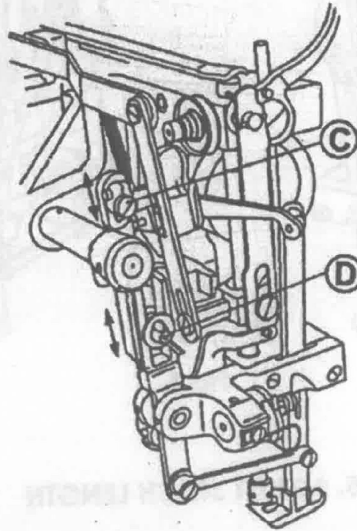

Fig.11

## 17. ADJUST NEEDLE THREAD

Turning the tension nut clockwise, increase tension of the needle thread.

Turning the tension nut counterclockwise, reduce the tension of the needle thread. Observe the Fig.12.

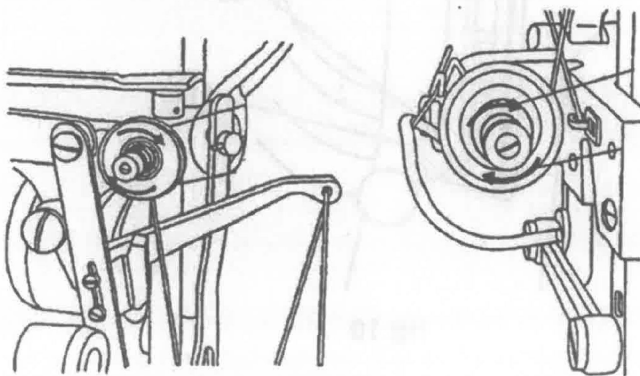

Fig.12



## 18. ADJUST PRESSURE OF PRESSER FOOT

The pressure of presser foot should be adjusted basing on sewing material. Observe the Fig.13, turn the nut clockwise or counterclockwise to adjust the pressure of presser foot.

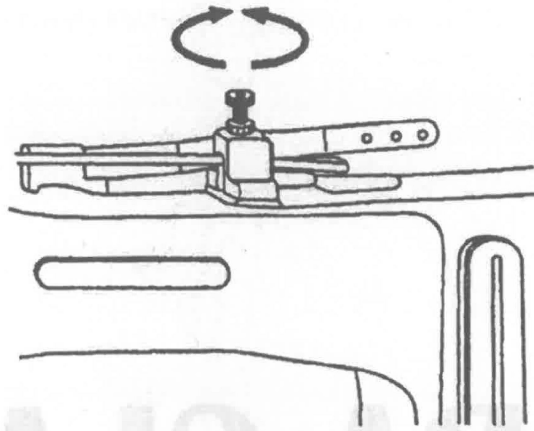

Fig.13

TOOL REQUIRED: 1/2" DRIVE TORQUE WRENCH

The pressure of ground load should be adjusted using an air line. Observe the pressure gauge and the pressure of the ground load. The pressure of the ground load should be adjusted using an air line.



# COBRA CLASS

## 7

### Parts List !!

## 1. CASTING COMPONENTS

| No. | Parts No. | Name                               | Qty | Remark       |
|-----|-----------|------------------------------------|-----|--------------|
| 1   | 7KT2-004  | Cover                              | 1   |              |
| 2   | 7KT2-005  | Screw                              | 3   |              |
| 3   | 7KT2-005  | Screw                              | 1   |              |
| 4   |           | Oil cup                            | 2   |              |
| 5   |           | Oil cup                            | 1   |              |
| 6   | 7KT2-006  | Cover                              | 1   |              |
| 7   | 7KT2-007  | Screw                              | 2   |              |
| 8   | 7KT2-008  | Take-up Lever Shield               | 1   |              |
| 9   | 13WF2-018 | Screw                              | 2   |              |
| 10  | 7KT2-009  | Face Plate                         | 1   |              |
| 11  | 7KT2-010  | Screw                              | 2   |              |
| 12  | 7KT2-011  | Slide Plate(L)                     | 1   |              |
| 13  | 7KT2-012  | Slide Plate(R)                     | 1   |              |
| 14  | 1WF2-044  | Screw                              | 2   |              |
| 15  | 7KT2-013  | Needle Plate                       | 1   |              |
| 16  | 7KT2-014  | Screw                              | 2   |              |
| 17  | 7KT2-015  | Tension Stud                       | 1   |              |
| 18  | 7KT2-016  | Tension Disc                       | 2   |              |
| 19  | 6K4-021   | Tension Spring                     | 1   |              |
| 20  | 7KT2-018  | Nut                                | 1   |              |
| 21  |           | Oil Cup                            | 3   |              |
| 22  | 7KT2-033  | Machine Supporting Bolt            | 4   |              |
| 23  |           | Washer                             | 4   | GB7244-87-14 |
| 24  | 7KT2-034  | Pin                                | 2   |              |
| 25  | 7KT2-035A | Name Plate                         | 1   |              |
| 26  | 16WF2-053 | Trademark Plate                    | 1   |              |
| 27  |           | Rivet                              | 4   |              |
| 28  | 1KT1-005  | Caution Plate                      | 1   |              |
| 29  | 7KT2-036  | Triangle Caution Plate             | 1   |              |
| 30  | 7KT2-001  | Housing                            | 1   |              |
| 31  | 7KT2-002  | Housing Plate                      | 1   |              |
| 32  | 7KT1-004  | Thread Take-up Lever Mounted Plate | 1   |              |
| 33  | 7KT1-003  | Screw                              | 3   |              |
| 34  | 7KT2-003  | Spring                             | 1   |              |
| 35  | 4KT1-005  | Serial No. Plate                   | 1   |              |
| 36  | 35WF1-054 | Rivet                              | 2   |              |

# 1. CASTING COMPONENTS

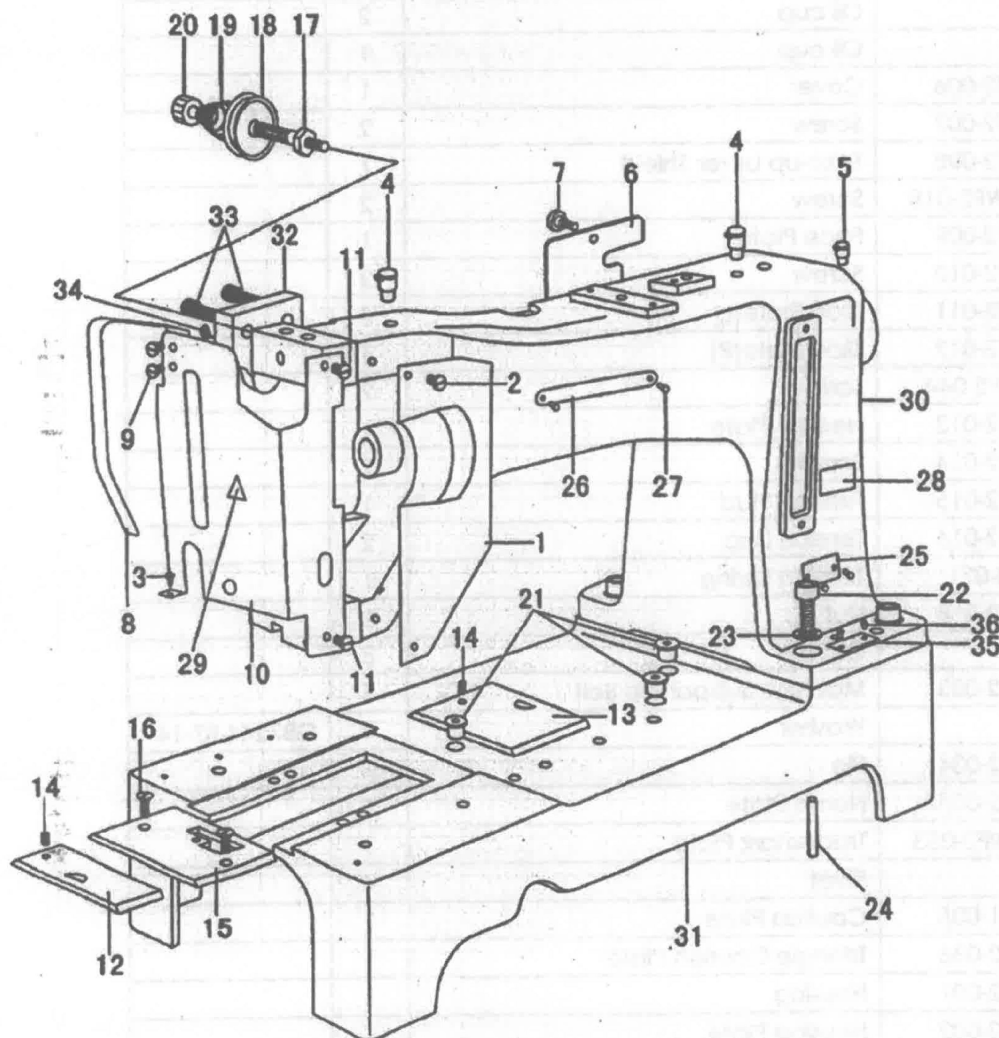

## 2. UPPER SHAFT AND THREAD TAKE-UP COMPONENTS

| No. | Parts No. | Name                   | Qty | Remark     |
|-----|-----------|------------------------|-----|------------|
| 1   | 7KT1-008  | Upper Shaft            | 1   |            |
| 2   | 7KT1-009  | Thread Take-up Cam     | 1   |            |
| 3   | 7KT1-010  | Screw                  | 2   |            |
| 4   | 7KT1-052  | Tapered Pin            | 1   |            |
| 5   | 7KT1-011  | Upper Shaft Bushing(R) | 1   |            |
| 6   | 7KT1-012  | Setscrew               | 1   |            |
| 7   | 7KT6-001  | Balance Wheel          | 1   |            |
| 8   | 7KT1-014  | Screw                  | 2   |            |
| 9   | 7KT1-002  | Thread Take-up Lever   | 1   |            |
| 10  | 7KT1-001  | Hinge Screw            | 1   |            |
| 11  | 7KT1-005  | Fulcrum Pin            | 1   |            |
| 12  | 7KT1-006  | Screw                  | 1   |            |
| 13  |           | Washer                 | 1   | GB859-87-8 |
| 14  | 7KT1-007  | Nut                    | 1   |            |
| 15  | 7KT1-015  | Hinge Screw            | 1   |            |
| 16  | 7KT1-016  | Nut                    | 1   |            |
| 17  | 7KT1-017  | Link                   | 1   |            |
| 18  | 7KT1-018  | Bushing                | 2   |            |
| 19  | 7KT1-019  | Setscrew               | 2   |            |
| 20  | 7KT1-020  | Needlebar Connect Stud | 1   |            |
| 21  | 7KT1-010  | Setscrew               | 2   |            |
| 22  | 7KT1-021  | Needlebar              | 1   |            |
| 23  | 7KT1-022  | Needle Clamp           | 1   |            |
| 24  | 7KT1-023  | Needle Clamp Screw     | 1   |            |
| 25  |           | Needle                 | 1   | 1000H 27#  |
| 26  | 7KT1-025  | Connecting Rod         | 1   |            |
| 27  | 7KT1-024  | Cap Screw              | 2   |            |
| 28  | 6K1-042   | Balance Wheel Screw    | 1   |            |

## 2. UPPER SHAFT AND THREAD TAKE-UP COMPONENTS

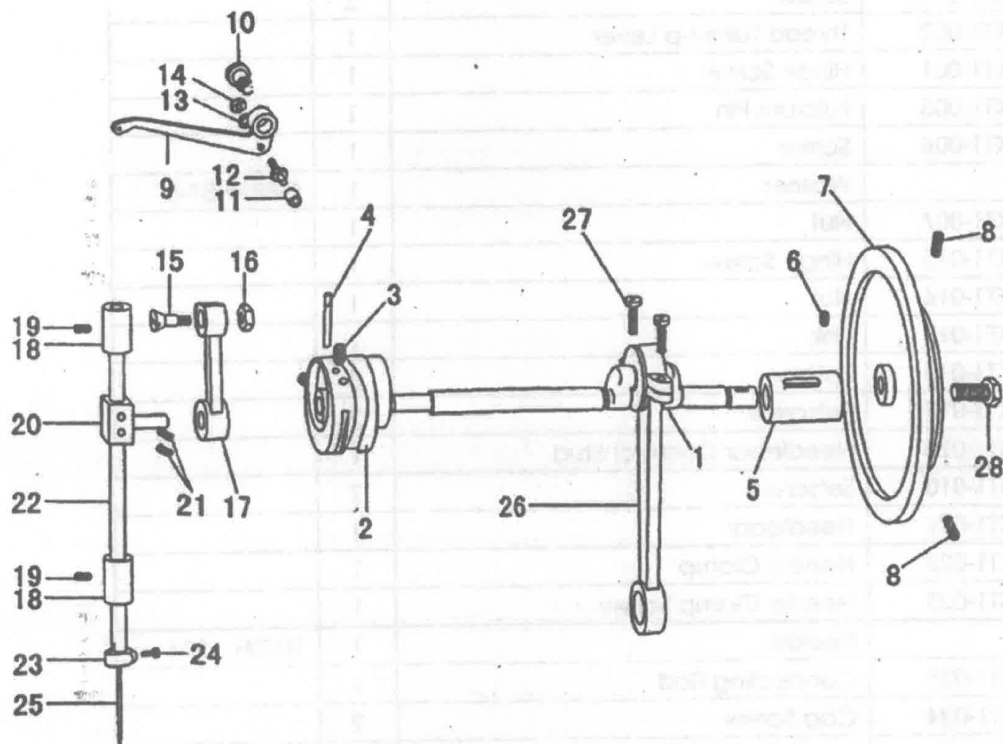

### 3. OSC. SHAFT AND SHUTTLE HOOK COMPONENTS

| No. | Parts No. | Name               | Qty | Remark  |
|-----|-----------|--------------------|-----|---------|
| 1   | 7KT1-031  | OSC. Shaft         | 1   |         |
| 2   | 7KT1-028  | Shuttle Driver     | 1   |         |
| 3   | 7KT1-010  | Setscrew           | 1   |         |
| 4   | 7KT1-053  | Pin                | 1   |         |
| 5   | 7KT1-029  | Shuttle Race Frame | 1   |         |
| 6   | 7KT1-030  | Screw              | 1   |         |
| 7   | 7KT1-046  | Bobbin             | 1   |         |
| 8   | 7KT1-048  | Shuttle Race       | 1   |         |
| 9   | 7KT1-047  | Setscrew           | 2   |         |
| 10  | 7KT1-049  | Race               | 1   |         |
| 11  | 7KT1-050  | Spring             | 1   |         |
| 12  | 7KT1-051  | Screw              | 1   |         |
| 13  |           | Shuttle            | 1   | KSP7-31 |
| 14  | 7KT1-043  | Collar 1           | 1   |         |
| 15  | 7KT1-044  | Collar 2           | 1   |         |
| 16  | 7KT1-045  | Setscrew           | 4   |         |
| 17  | 7KT1-036  | OSC. Shuttle Crank | 1   |         |
| 18  | 7KT1-053  | Pin                | 1   |         |
| 19  | 7KT1-010  | Setscrew           | 2   |         |
| 20  | 7KT1-038  | Slide Shuttle      | 1   |         |
| 21  | 7KT1-039  | Spacer             | 1   |         |
| 22  | 7KT1-040  | Nut                | 1   |         |
| 23  | 7KT1-041  | Slide Plate        | 1   |         |
| 24  | 7KT1-042  | Screw              | 1   |         |
| 25  | 7KT1-037  | OSC. Rock Shuttle  | 1   |         |
| 26  | 7KT1-032  | Oil Tube Packing   | 1   |         |
| 27  | 7KT1-033  | Nut                | 2   |         |
| 28  | 7KT1-034  | Stud               | 1   |         |
| 29  | 7KT1-035  | Hinge Pin          | 1   |         |
| 30  | 7KT1-026  | Hinge Screw        | 1   |         |
| 31  | 7KT1-027  | Nut                | 1   |         |

### 3. OSC. SHAFT AND SHUTTLE HOOK COMPONENTS

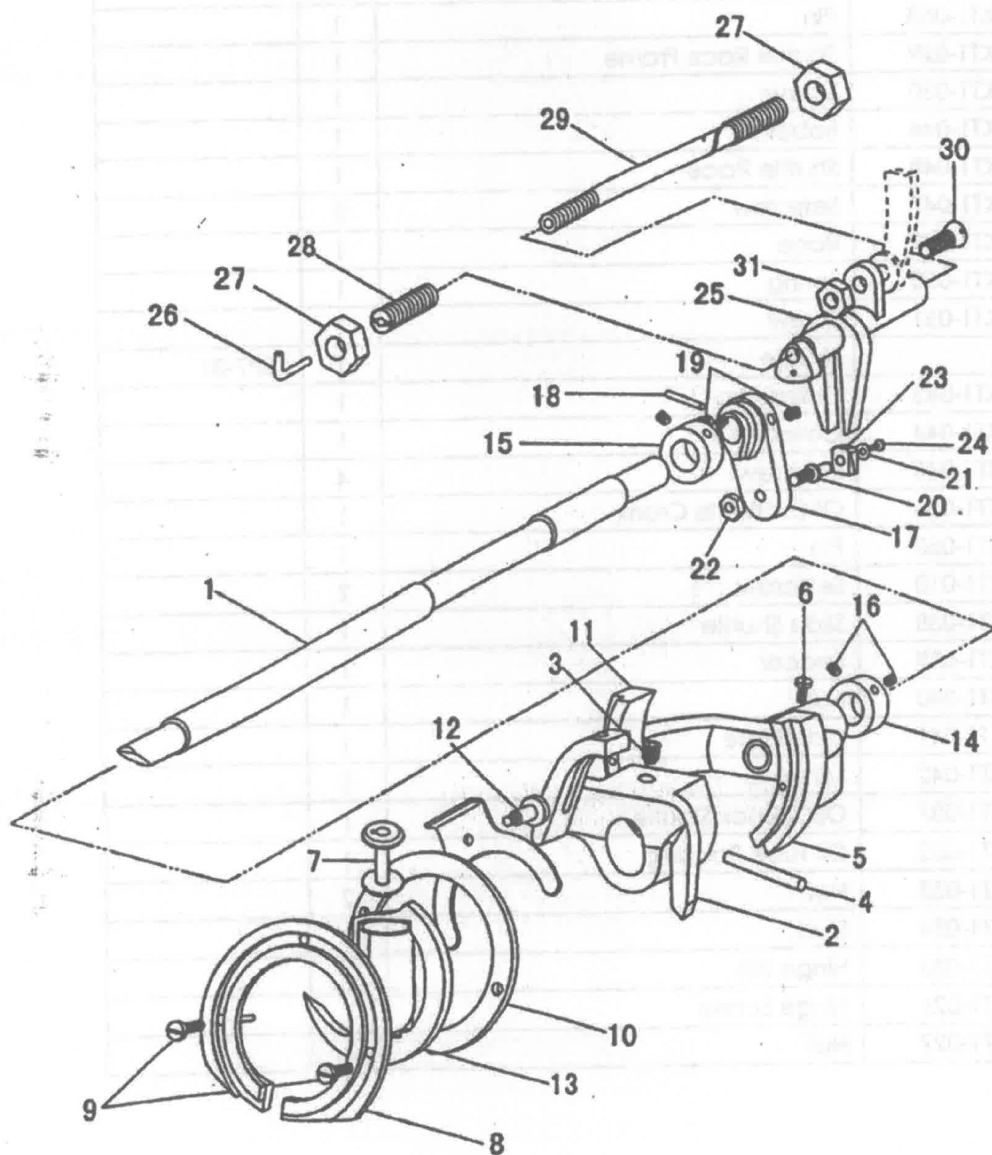



#### 4. PRESSER COMPONENTS

| No. | Parts No.  | Name                | Qty | Remark       |
|-----|------------|---------------------|-----|--------------|
| 1   | 7KT3-021   | Slide Block         | 1   |              |
| 2   | 7KT3-022   | Sleeve              | 1   |              |
| 3   | 7KT3-023   | Sleeve              | 1   |              |
| 4   | 7KT3-028   | Presser Bar         | 1   |              |
| 5   | 7KT1-018   | Bushing             | 1   |              |
| 6   | 7KT5-002   | Setscrew            | 1   |              |
| 7   | 22T2-005B3 | Setscrew            | 1   |              |
| 8   | 7KT3-029   | Presser Foot        | 1   |              |
| 9   | 7KT3-013   | Spring              | 1   |              |
| 10  | 7KT3-014   | Pin                 | 1   |              |
| 11  | 7KT3-012   | Bracket             | 1   |              |
| 12  | 7KT3-011   | Screw               | 2   |              |
| 13  | 7KT3-009   | Bolt                | 1   |              |
| 14  | 7KT3-010   | Nut                 | 1   |              |
| 15  | 7KT3-024   | Shield Mounted Base | 1   |              |
| 16  | 7KT3-025   | Shield              | 1   |              |
| 17  | 7KT3-026   | Setscrew            | 1   |              |
| 18  | 7KT3-027   | Setscrew            | 1   |              |
| 19  | 7KT3-004   | Lifter              | 1   |              |
| 20  | 7KT3-003   | Washer              | 1   |              |
| 21  | 7KT3-002   | Stud                | 1   |              |
| 22  | 7KT3-001   | Washer              | 1   |              |
| 23  |            | Spacer              | 1   | GB879-86 3×2 |
| 24  | 7KT3-006   | Bracket             | 1   |              |
| 25  | 7KT3-005   | Screw               | 2   |              |
| 26  | 7KT3-007   | Nut                 | 1   |              |
| 27  | 7KT3-008   | Stud                | 1   |              |
| 28  | 7KT3-017   | Hinge Screw         | 1   |              |
| 29  | 7KT3-018   | Bar                 | 1   |              |
| 30  | 37T4-416   | Screw               | 2   |              |
| 31  |            | Nut                 | 2   | GB97.1-85-4  |
| 32  | 7KT3-019   | Bracket             | 1   |              |
| 33  | 7KT3-020   | Hinge Screw         | 1   |              |
| 34  | 7KT3-015   | Bar                 | 1   |              |
| 35  | 7KT3-016   | Screw               | 1   |              |
| 36  | 7KT3-041   | Flat Spring         | 1   |              |
| 37  | 7KT3-039   | Screw               | 1   |              |
| 38  | 7KT3-038   | Nut                 | 1   |              |
| 39  | 7KT3-037   | Spring              | 1   |              |
| 40  | 7KT3-036   | Screw               | 1   |              |

#### 4. PRESSER COMPONENTS

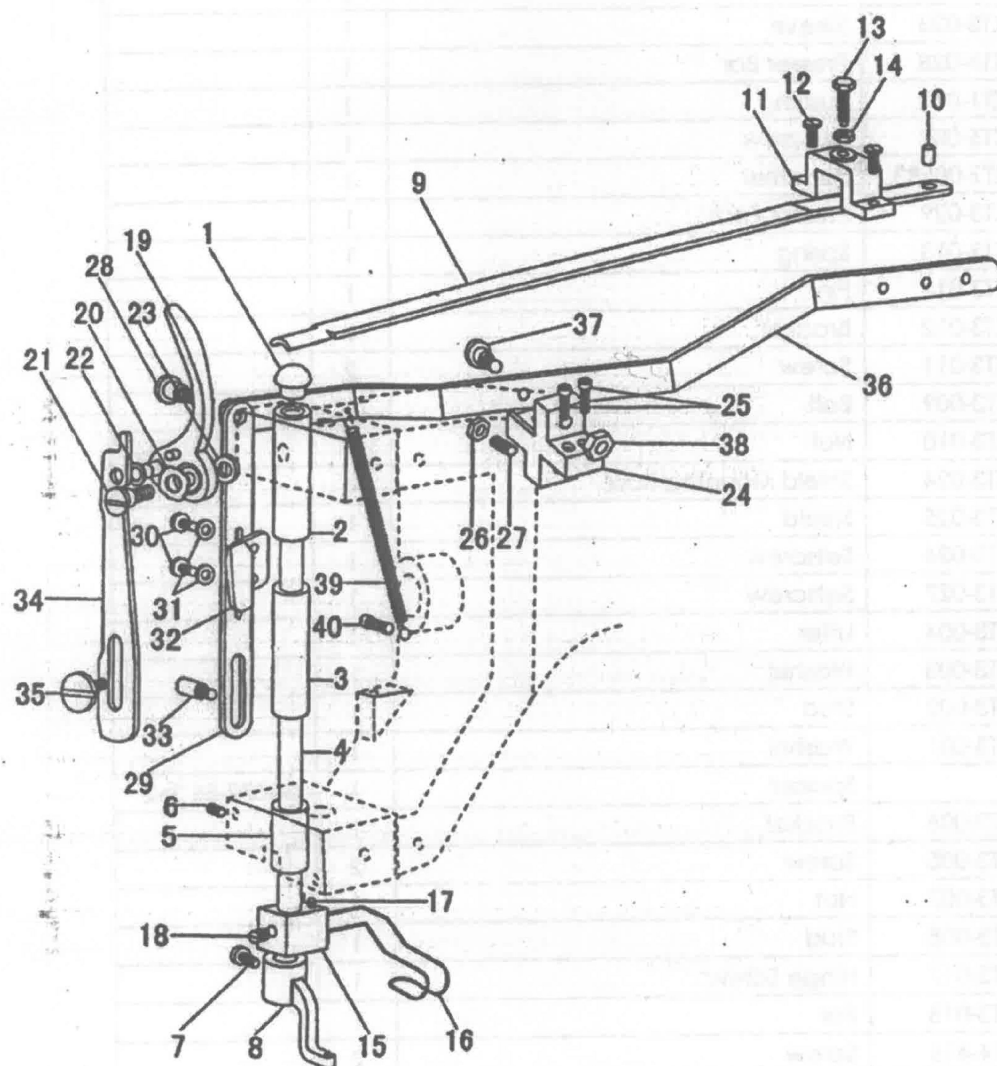

## 5. LOWER FEEDING COMPONENTS

| No. | Parts No. | Name                 | Qty | Remark |
|-----|-----------|----------------------|-----|--------|
| 1   | 7KT4-001  | Feed Bar             | 1   |        |
| 2   | 7KT4-002  | Screw                | 1   |        |
| 3   | 7KT4-003  | Feed Dog             | 1   |        |
| 4   | 7KT4-004  | Screw                | 2   |        |
| 5   | 7KT1-016  | Nut                  | 2   |        |
| 6   | 7KT4-005  | Feed Rock Shuttle    | 1   |        |
| 7   | 7KT4-006  | Screw                | 2   |        |
| 8   | 7KT4-007  | Screw                | 2   |        |
| 9   | 7KT1-033  | Nut                  | 4   |        |
| 10  | 7KT4-012  | Rock Shuttle         | 1   |        |
| 11  | 7KT4-015  | Plate                | 1   |        |
| 12  | 7KT1-030  | Screw                | 1   |        |
| 13  | 7KT5-055  | Pin                  | 1   |        |
| 14  | 7KT4-008  | Crank                | 1   |        |
| 15  | 7KT4-009  | Screw                | 1   |        |
| 16  | 7KT4-010  | Fulcrum Pin          | 1   |        |
| 17  | 7KT4-011  | Roller               | 1   |        |
| 18  | 7KT4-016  | Stitch Regulate Cam  | 1   |        |
| 19  | 7KT1-010  | Setscrew             | 2   |        |
| 20  | 7KT4-025  | Stitch Regulate Fork | 1   |        |
| 21  | 7KT4-026  | Screw                | 3   |        |
| 22  | 7KT1-016  | Nut                  | 3   |        |
| 23  | 7KT4-013  | Screw                | 1   |        |
| 24  | 7KT4-014  | Crank                | 1   |        |
| 25  | 7KT4-020  | Arm                  | 1   |        |
| 26  | 7KT4-023  | Fulcrum Pin          | 1   |        |
| 27  | 7KT4-024  | Screw                | 1   |        |
| 28  | 7KT4-019  | Screw                | 1   |        |
| 29  | 7KT4-017  | Stitch Regulate Link | 1   |        |
| 30  | 7KT4-022  | Screw                | 1   |        |
| 31  | 7KT4-021  | Nut                  | 1   |        |
| 32  | 7KT4-027  | Spring               | 1   |        |
| 33  | 7KT4-028  | Stitch Regulate Stud | 1   |        |
| 34  | 7KT4-018  | Screw                | 1   |        |
| 35  | 7KT4-029  | Stitch Plate         | 1   |        |
| 36  | 7KT4-030  | Screw                | 2   |        |
| 37  | 7KT4-031  | Nut                  | 1   |        |
| 38  | 7KT4-032  | Washer               | 1   |        |
| 39  | 7KT4-033  | Nut                  | 1   |        |
| 40  | 7KT4-034  | Ball Handle          | 1   |        |

|    |          |       |   |  |
|----|----------|-------|---|--|
| 41 | 7KT4-035 | Screw | 2 |  |
| 42 | 7KT4-036 | Plate | 1 |  |

## 5. LOWER FEEDING COMPONENTS

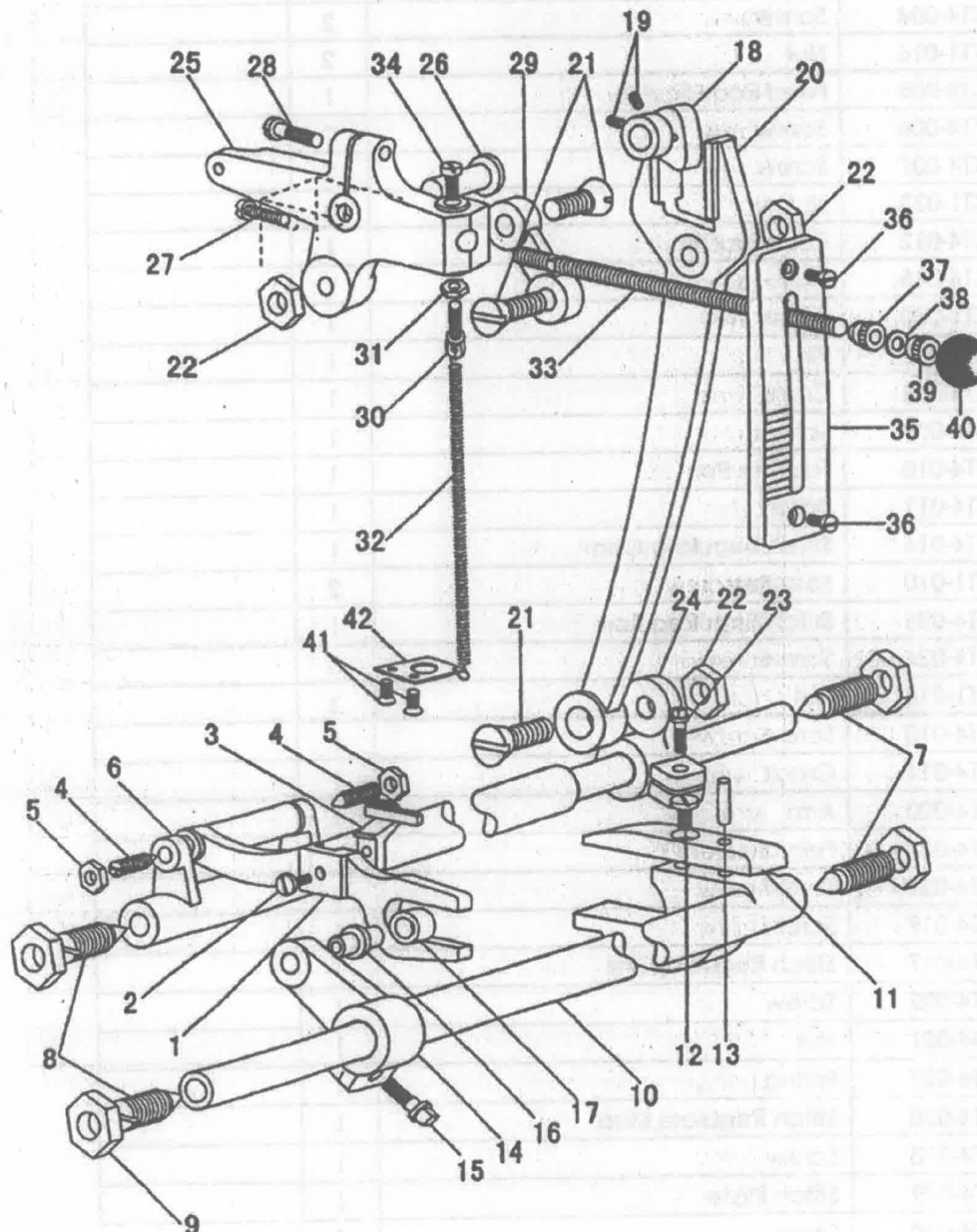

## 6. UPPER FEEDING AND THREAD TENSION COMPONENTS

| No. | Parts No. | Name                     | Qty | Remark |
|-----|-----------|--------------------------|-----|--------|
| 1   | 7KT5-001  | Sleeve                   | 1   |        |
| 2   | 7KT5-057  | Shaft                    | 1   |        |
| 3   | 7KT5-004  | Friction Washer          | 1   |        |
| 4   | 7KT5-005  | Screw                    | 2   |        |
| 5   | 7KT5-002  | Screw                    | 3   |        |
| 6   | 7KT5-008  | Crank                    | 1   |        |
| 7   | 7KT5-056  | Pin                      | 1   |        |
| 8   | 7KT1-010  | Screw                    | 1   |        |
| 9   | 7KT5-009  | Screw                    | 1   |        |
| 10  | 7KT5-010  | Sleeve                   | 1   |        |
| 11  | 7KT5-011  | Slide Block              | 1   |        |
| 12  | 7KT5-012  | Washer                   | 1   |        |
| 13  | 22WF1-020 | Wing Nut                 | 1   |        |
| 14  | 7KT5-013  | Feed Bar                 | 1   |        |
| 15  | 7KT5-014  | Collar                   | 2   |        |
| 16  | 7KT5-015  | Pin                      | 1   |        |
| 17  | 7KT5-016  | Screw                    | 1   |        |
| 18  | 22WF1-020 | Setscrew                 | 2   |        |
| 19  | 7KT5-043  | Rod Connector            | 1   |        |
| 20  | 7KT5-044  | Screw                    | 1   |        |
| 21  | 7KT5-045  | Screw                    | 1   |        |
| 22  | 7KT5-046  | Screw                    | 1   |        |
| 23  | 7KT5-047  | Washer                   | 1   |        |
| 24  | 7KT5-048  | Link                     | 1   |        |
| 25  | 7KT5-049  | Screw                    | 1   |        |
| 26  | 7KT5-050  | Nut                      | 1   |        |
| 27  | 7KT5-051  | Alternating Presser foot | 1   |        |
| 28  | 7KT5-041  | Saddle                   | 1   |        |
| 29  | 7KT5-042  | Pin                      | 2   |        |
| 30  | 7KT5-058  | Screw                    | 2   |        |
| 31  | 7KT2-019  | Screw                    | 1   |        |
| 32  | 7KT2-020  | Wahser                   | 1   |        |
| 33  | 7KT2-021  | Eyelet                   | 1   |        |
| 34  | 7KT2-022  | Screw                    | 1   |        |
| 35  | 7KT2-023  | Spring Regulator         | 1   |        |
| 36  | 7KT2-024  | Setscrew                 | 1   |        |
| 37  | 7KT2-025  | Sleeve                   | 1   |        |
| 38  | 6K4-015   | Spring                   | 1   |        |
| 39  | 7KT2-026  | Check Spring             | 1   |        |
| 40  | 7KT2-027  | Washer                   | 1   |        |

|    |           |                |   |  |
|----|-----------|----------------|---|--|
| 41 | 7KT2-028  | Tension Screw  | 1 |  |
| 42 | 7KT2-029  | Tension Disc   | 1 |  |
| 43 | 7KT2-030  | Tension Plate  | 1 |  |
| 44 | 7KT2-032  | Tension Spring | 1 |  |
| 45 | 7KT2-018  | Nut            | 1 |  |
| 46 | 16WF2-012 | Spacer         | 1 |  |
| 47 | 16WF2-015 | Screw          | 1 |  |
| 48 | 7KT5-028  | Crank          | 1 |  |
| 49 | 7KT1-003  | Screw          | 2 |  |
| 50 | 7KT5-029  | Screw          |   |  |
| 51 | 7KT5-030  | Pin            | 1 |  |
| 52 | 7KT5-031  | Connecting Rod | 1 |  |
| 53 | 7KT5-032  | Pin            | 1 |  |
| 54 | 7KT5-033  | Crank          | 1 |  |
| 55 | 7KT4-029  | Screw          | 1 |  |
| 56 | 7KT1-003  | Screw          | 1 |  |
| 57 | 7KT5-007  | Bushing        | 1 |  |
| 58 | 7KT5-006  | Screw          | 4 |  |
| 59 | 7KT5-003  | Bracket        | 1 |  |
| 60 | 7KT5-053  | Taper Pin      | 2 |  |



## 6. UPPER FEEDING AND THREAD TENSION COMPONENTS

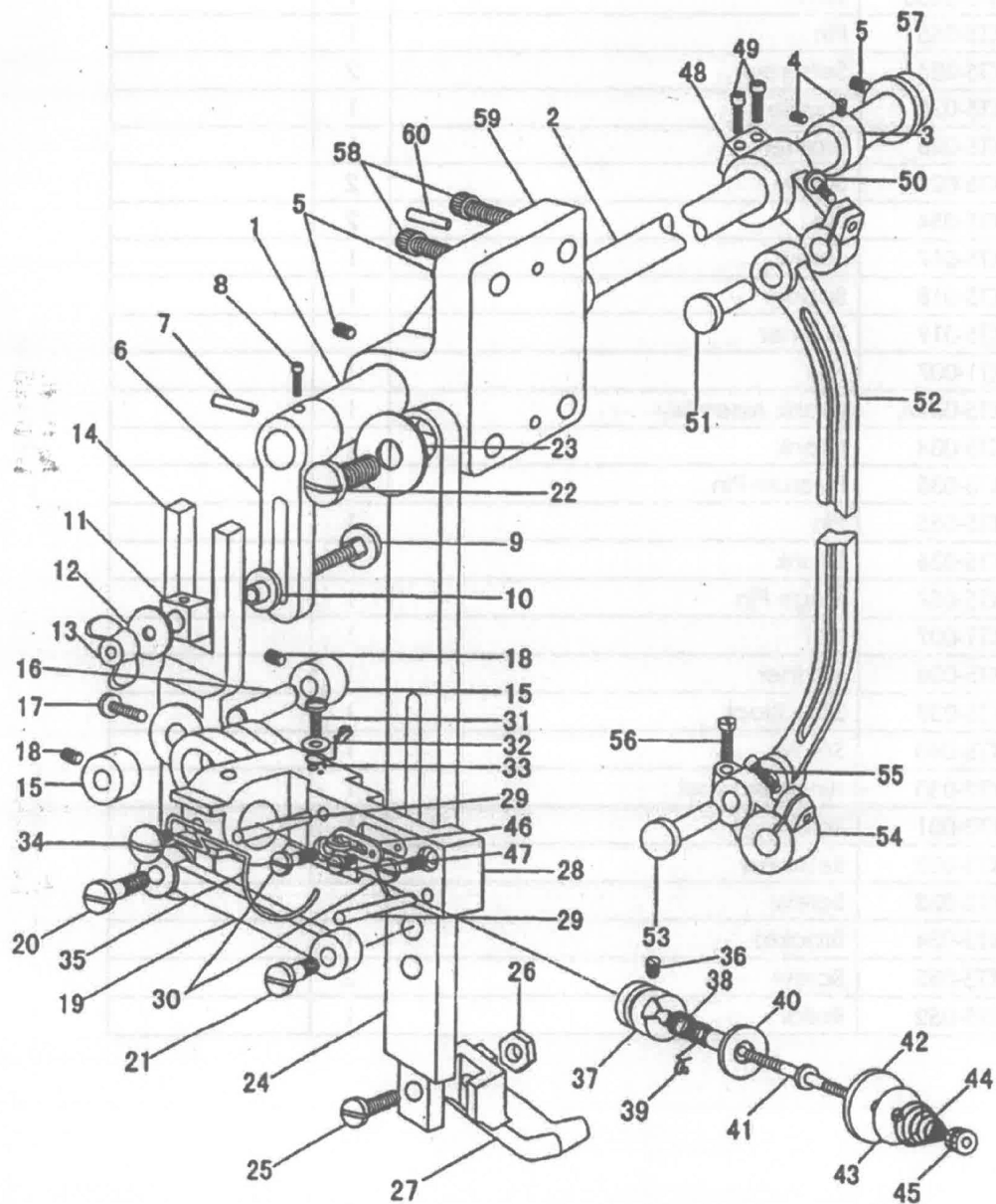

## 7. LIFT COMPONENTS

| No. | Parts No. | Name           | Qty | Remark |
|-----|-----------|----------------|-----|--------|
| 1   | 7KT5-020  | Screw          | 2   |        |
| 2   | 7KT5-021  | Nut            | 2   |        |
| 3   | 7KT5-022  | Strap          | 1   |        |
| 4   | 7KT5-0233 | Arm            | 1   |        |
| 5   | 7KT5-055  | Pin            | 1   |        |
| 6   | 7KT5-024  | Setscrew       | 2   |        |
| 7   | 7KT5-025  | Shuttle        | 1   |        |
| 8   | 7KT5-026  | Bracket        | 1   |        |
| 9   | 7KT5-027  | Screw          | 2   |        |
| 10  | 7KT5-054  | Pin            | 2   |        |
| 11  | 7KT5-017  | Screw          | 1   |        |
| 12  | 7KT5-018  | Spacer         | 1   |        |
| 13  | 7KT5-019  | Washer         | 1   |        |
| 14  | 7KT1-007  | Nut            | 1   |        |
| 15  | 7KT5-034A | Crank Assembly | 1   |        |
| 16  | 7KT5-034  | Crank          | 1   |        |
| 17  | 7KT5-035  | Fulcrum Pin    | 1   |        |
| 18  | 7KT5-055  | Pin            | 1   |        |
| 19  | 7KT5-036  | Crank          | 1   |        |
| 20  | 7KT5-037  | Hinge Pin      | 1   |        |
| 21  | 7KT1-007  | Nut            | 1   |        |
| 22  | 7KT5-038  | Washer         | 1   |        |
| 23  | 7KT5-039  | Slide Block    | 1   |        |
| 24  | 7KT5-040  | Screw          | 1   |        |
| 25  | 7KT3-030  | Hinge Bracket  | 1   |        |
| 26  | 7KT3-031  | Screw          | 1   |        |
| 27  | 7KT3-032  | Setscrew       | 1   |        |
| 28  | 7KT3-033  | Screw          | 1   |        |
| 29  | 7KT3-034  | Bracket        | 1   |        |
| 30  | 7KT3-035  | Screw          | 2   |        |
| 31  | 7KT5-052  | Rollar         | 1   |        |



## 7. LIFT COMPONENTS

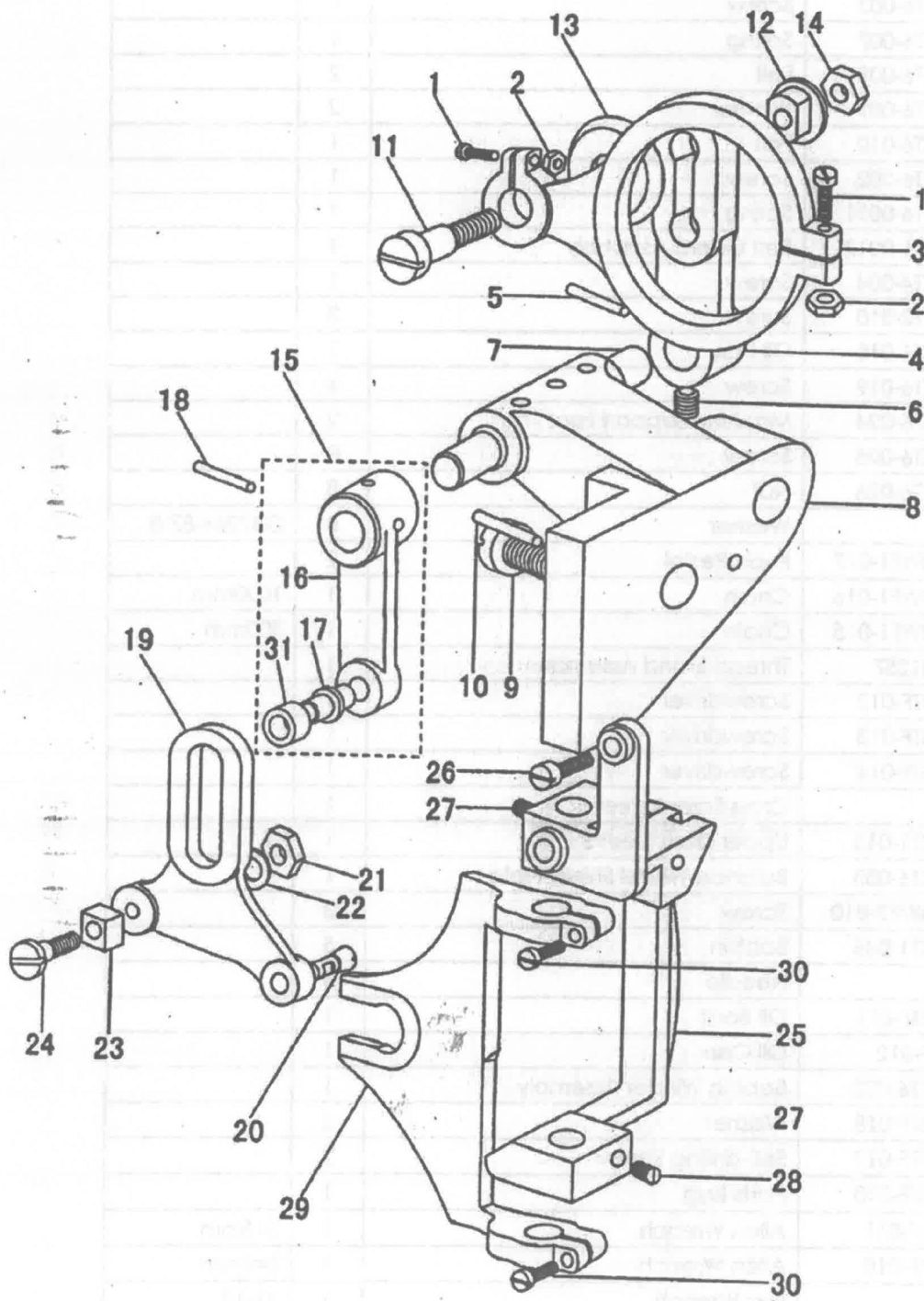

## 8. ACCESSORIES

| No. | Parts No. | Name                       | Qty | Remark      |
|-----|-----------|----------------------------|-----|-------------|
| 1   | 7KT6-004  | Oil Box Assembly           | 1   |             |
| 2   | 7KT6-003  | Screw                      | 1   |             |
| 3   | 7KT6-007  | Spring                     | 1   |             |
| 4   | 7KT6-008  | Felt                       | 2   |             |
| 5   | 7KT6-009  | Washer                     | 2   |             |
| 6   | 7KT6-010  | Felt                       | 1   |             |
| 7   | 7KT6-002  | Screw                      | 1   |             |
| 8   | 7KT6-0011 | Spring                     | 1   |             |
| 9   | 7KT6-0012 | Belt Guard Assembly        | 1   |             |
| 10  | 7KT4-004  | Screw                      | 1   |             |
| 11  | 7KT2-010  | Screw                      | 3   |             |
| 12  | 7KT6-018  | Oil Pan                    | 1   |             |
| 13  | 7KT6-019  | Screw                      | 4   |             |
| 14  | 7KT6-024  | Machine Support Foot       | 2   |             |
| 15  | 7KT6-025  | Screw                      | 8   |             |
| 16  | 7KT6-026  | Nut                        | 8   |             |
| 17  |           | Washer                     | 8   | GB7244-87-8 |
| 18  | 18WF1-017 | Food Pedal                 | 2   |             |
| 19  | 18WF1-016 | Chain                      | 1   | 1000mm      |
| 20  | 18WF1-015 | Chain                      | 1   | 500mm       |
| 21  | 721257    | Thread Stand Assembly      | 1   |             |
| 22  | 33TF-012  | Screwdriver                | 1   |             |
| 23  | 33TF-013  | Screwdriver                | 1   |             |
| 24  | 33TF-014  | Screwdriver                | 1   |             |
| 25  |           | Cross Screwdriver          | 1   |             |
| 26  | 7KT1-013  | Upper Shaft Sleeve         | 1   |             |
| 27  | 7KT6-033  | Balance Wheel Shield Plate | 1   |             |
| 28  | 13WF2-010 | Screw                      | 3   |             |
| 29  | 7KT1-046  | Bobbin                     | 5   |             |
| 30  |           | Needle                     | 5   |             |
| 31  | 33TF-011  | Oil Boat                   | 1   |             |
| 32  | 1F-012    | Oil Can                    | 1   |             |
| 33  | 7KT6-030  | Bobbin Winder Assembly     | 1   |             |
| 34  | 33TF-018  | Washer                     | 2   |             |
| 35  | 33TF-017  | Self-drilling Screw        | 2   |             |
| 36  | 33TF-010  | Parts Bag                  | 1   |             |
| 37  | 13F-011   | Allen Wrench               | 1   | S=5mm       |
| 38  | 13F-010   | Allen Wrench               | 1   | S=4mm       |
| 39  |           | Box Wrench                 | 1   | 11-12       |
| 40  | 7KT6-020  | Motor Mounted Plate        | 1   |             |

|    |          |             |   |        |
|----|----------|-------------|---|--------|
| 41 | 7KT6-021 | Washer      | 2 |        |
| 42 | 7KT6-022 | Screw       | 2 |        |
| 43 | 7KT6-023 | Nut         | 2 |        |
| 44 |          | Timing Belt | 1 | 1400mm |

## 8. ACCESSORIES

